



**ADOR USA**

AUTOMATIC DOOR OPENER

AdorUSA.com



**THE SIMPLEST  
WAY TO OPEN**

[www.AdorUSA.com](http://www.AdorUSA.com)

[AdorUSA@gmail.com](mailto:AdorUSA@gmail.com)

216.214.0828



## Quick, strong, toothed and based on gear train



**Our rack-and-pinion drive called CROCO was designed to open and close sliding doors in buses. It has an ability to cope with any sustained load. CROCO continues working during 24 hours without any interruptions and overheating. Its resources include more than 800 000 cycles, it means more than 5 years of continued operation. Our drive may be installed in any bus because of its universality.**

- One of its peculiarities is a new reversible reduction gear. Having installed our drive you may freely open and close the door without disassembling the system.
- Our CROCO is the most powerful in its category. It has a powerful and compact motor. This motor provides the pull up to 30 kg. It can close completely even the biggest doors from any positions.
- CROCO has the highest speed among the drives of this type - 0.3 m/sec. It takes about 2 or 3 seconds to close the door ( for analogous drives - 4-6 sec).
- Our rack-and-pinion drive is controlled with the help of the button located on a gage panel. The additional button of this kind can be installed in a passenger compartment according to the customer's order. There is also a remote control as an option.
- CROCO has got a safety equipment certificate ГOCT P 41.107-99 ( regulations of Economic Commission for Europe № 52), an automatic rollback, a mechanical emergency opening system.

- CROCO is perfectly in harmony with any interior of the bus. The rack and pinion mechanism is hidden from the passengers. CROCO's color spectrum is steady that is why the dust is practically invisible on it.
- There is a tightening screw for door adjustment. The design of this tightening screw makes it simple to install and adjust our rack-and-pinion drive.
- The required installation time is 2 or 4 hours. It depends greatly upon kitting and experience of the mounter. Most of the units are partly assembled and adjusted by manufacturer.

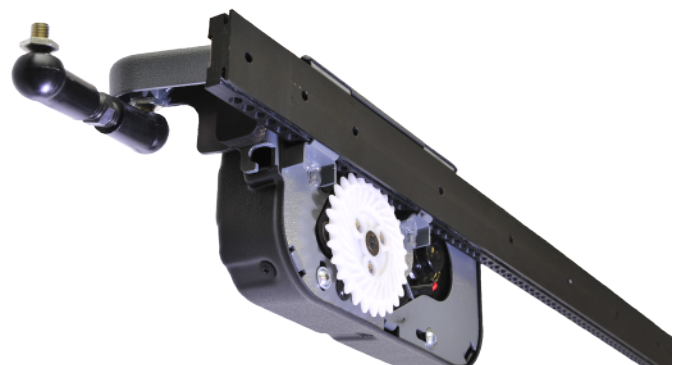

## Spec characteristics

Resources (not less)	800 000 cycles
Installation time	4 hours (It depends upon kitting and experience of the mounter)
Permissible service temperature	from - 25°C up to + 40°C
Power consumption (max)	250 watt
Opening speed	0.3 m/sec
Closing speed	0.3 m/sec
Functions:	Opening, closing, stopping Remote control (as an option) Adjustment of opening width Operation mode with fixation/ without fixation Automatic rollback (when encountering an obstruction, the controller reverses the door)

**Automatic rollback  
(when encountering an obstruction, the controller reverses the door)**

Pic. 1



Pic. 2



Pic. 3



## Manual mode in case of breakdown

Safety:

Mechanical door opening from inside

Mechanical door opening from outside

Warning stickers

Automatic rollback (when encountering an obstruction, the controller reverses the door)



**Manual door opening from inside**

Pic. 1

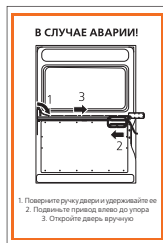

Pic. 2



Pic. 3



**Manual door opening from outside**

Pic. 1



Pic. 2

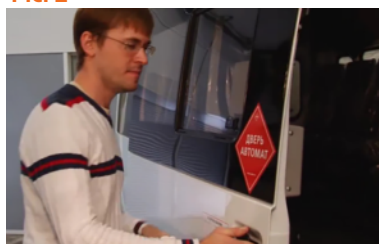

Pic. 3





## Location

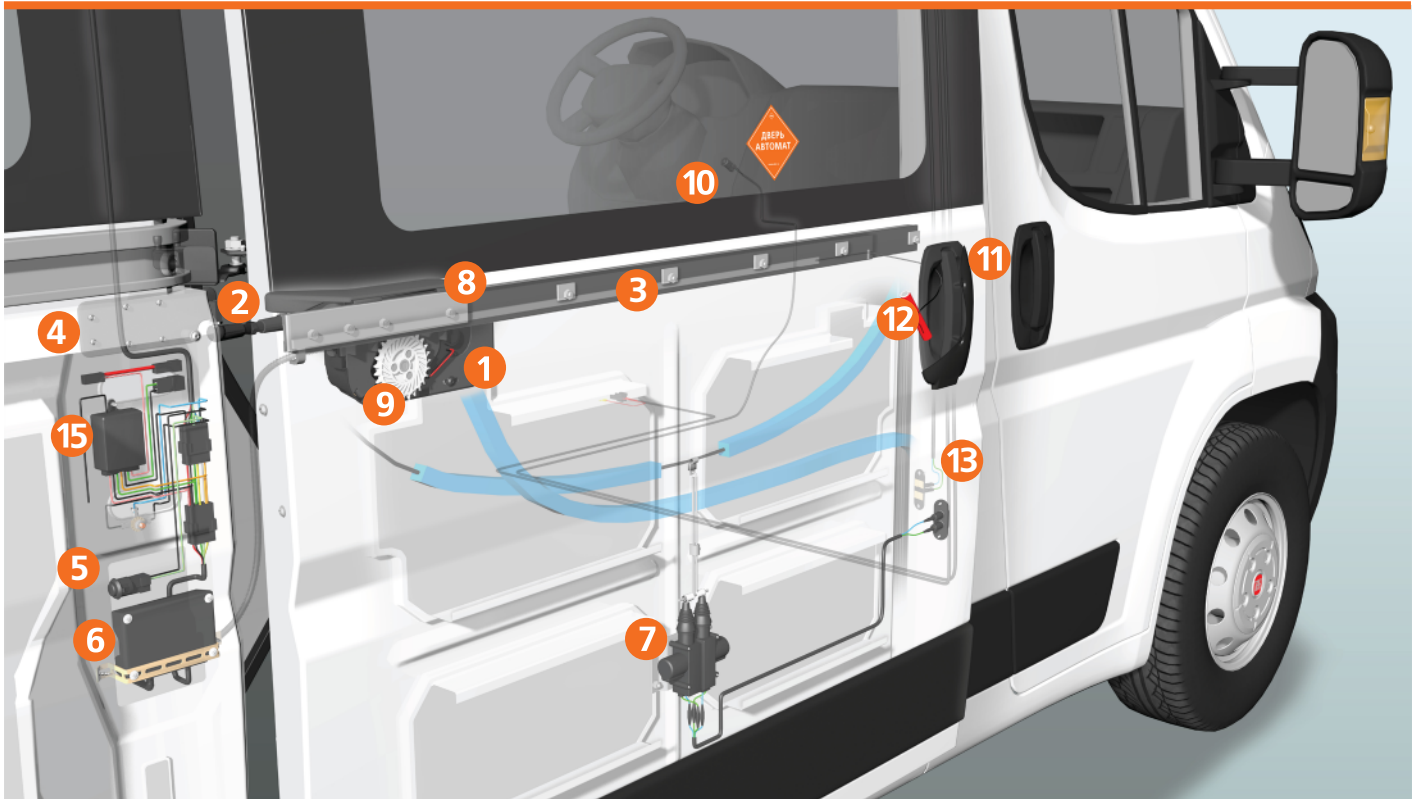

- 1. Door drive
- 2. Rod
- 3. Rack
- 4. Cradle
- 5. Additional button

- 6. Controller
- 7. Latch actuator
- 8. Plate for rack
- 9. Pinion
- 10. Control button

- 11. Handle cover
- 12. Cable for emergency opening
- 13. Limit switch
- 14. Flange
- 15. Remote control

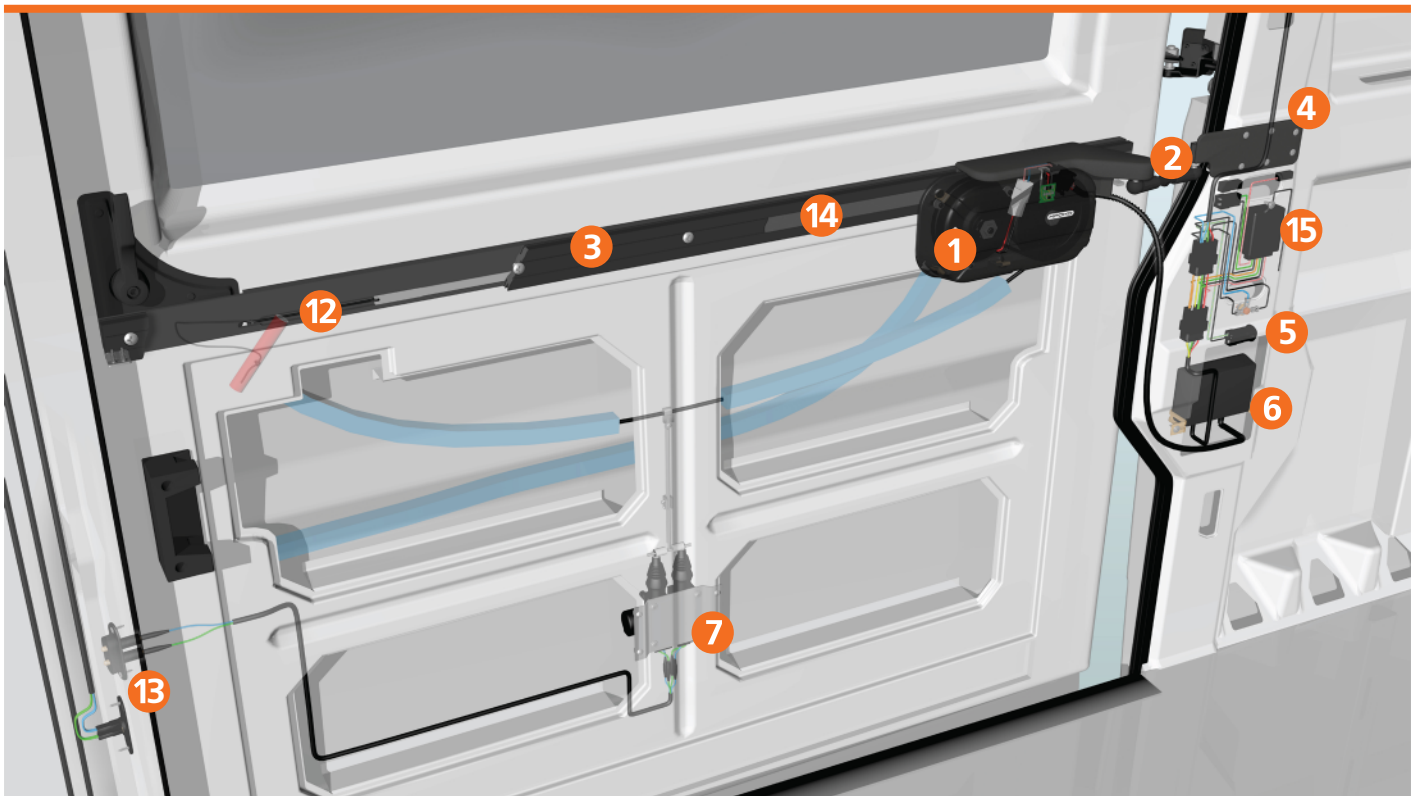

## Standard

(for all types of minibuses)

Rack-and-pinion drive

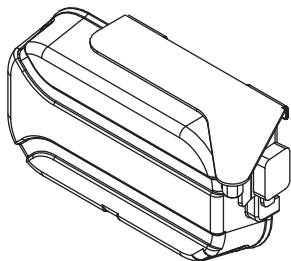

Main wiring harness

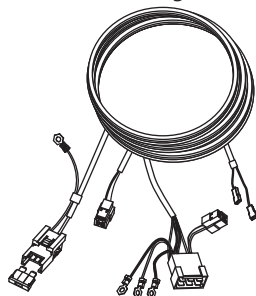

Controller

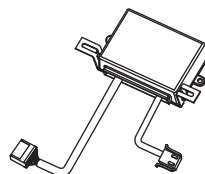

Operating manual



Rack

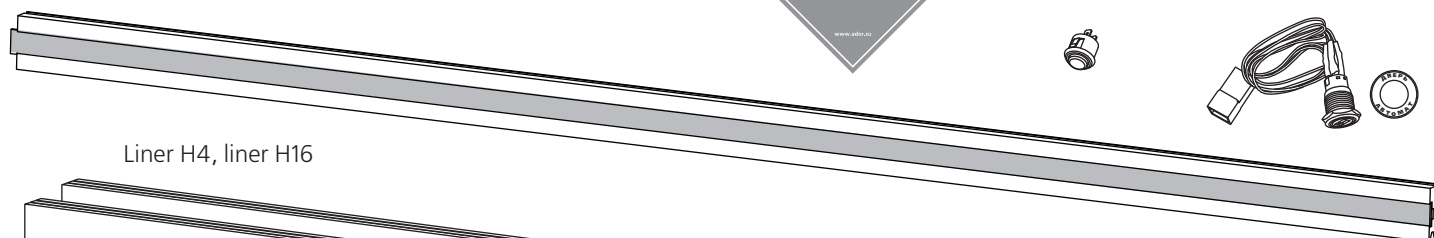

Warning sticker



Backup button



Control button



Liner H4, liner H16

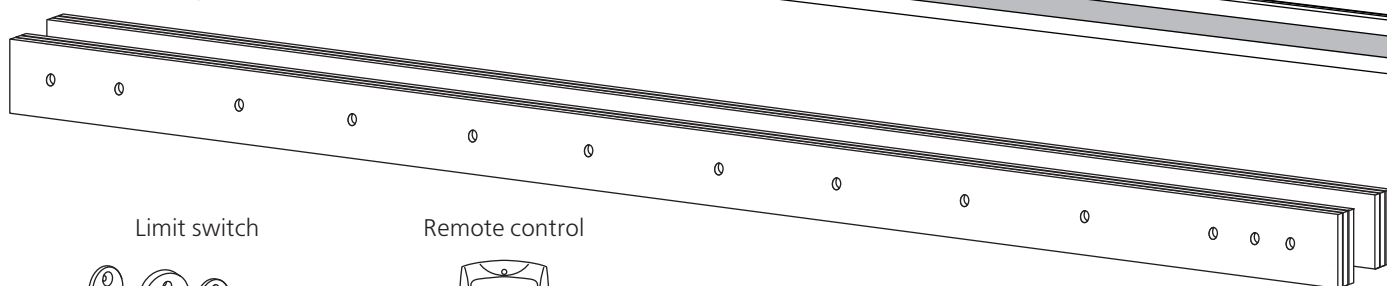

Limit switch

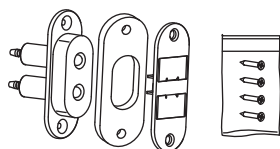

Remote control



Cradles and rods for different types of buses

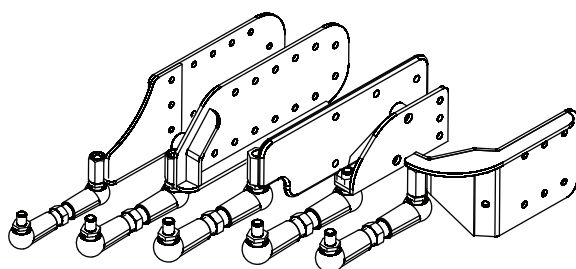

Actuator wiring harness for different types of buses

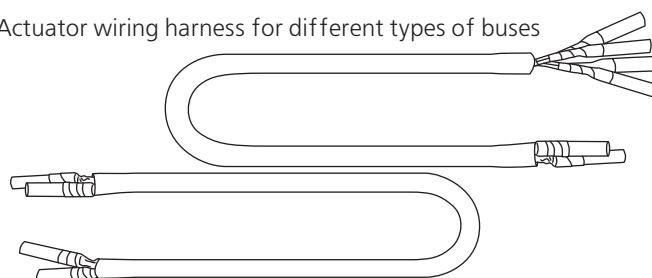

Latch actuators for different types of buses

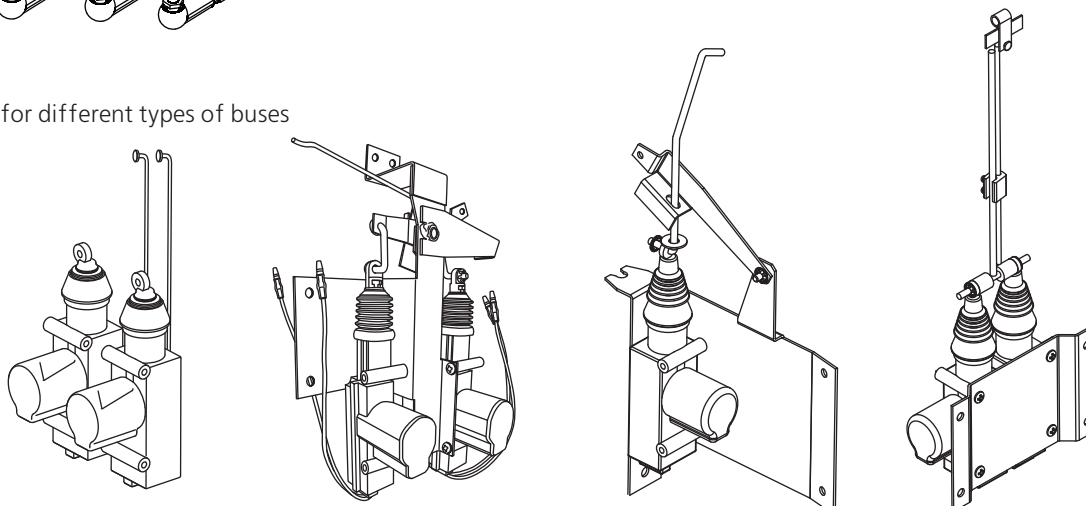

## Standard (for all types of minibuses)

Outer handle covers for different types of buses

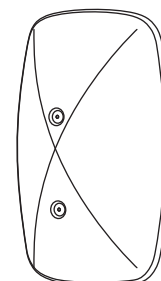
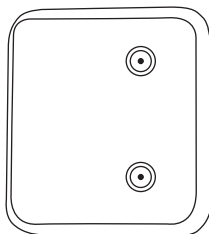
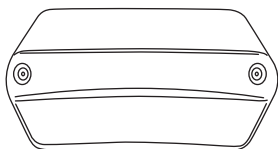

Inner handle covers for different types of buses

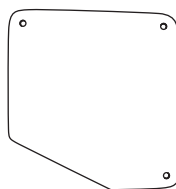
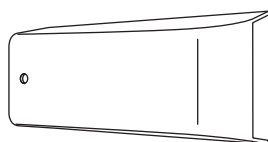

## Normative legal documents

Certificate of conformance TY 4513-005-72222539-2012,  
regulations of Economic Commission for Europe № 107;  
ГОСТ 41.52-2005.



## Contacts

www.AdorUSA.com  
AdorUSA@gmail.com  
216.214.0828

